

SWC Atherton St & Ximeno Ave | Long Beach, CA

Restaurant Leasing Opportunity in New Development

In a Densely Populated Coastal Community



For leasing, please contact:

Mitchell Hernandez
Lic. 01875229
T +1 310 430 7790 x 102
mitchell.hernandez@betaagency.com

Richard Rizika
Lic. 01044064
T +1 310 430 7790 x 101
richard.rizika@betaagency.com

beta.



- **Located in the Traffic Circle Hub**, one of the premier business corridors within the Long Beach Market.
- Surrounded by a mix of **national retailers, service businesses, and dining options**, including Starbucks, Marshalls, and CVS.
- **1,167 SF** remaining retail space, ideal for quick-service restaurant (QSR) or food-related businesses.
- **Existing Buildout:** Currently configured as a **Jimmy John's**, the space includes built-in sandwich prep areas, counters, seating, and kitchen equipment.
- **Modern Infrastructure:** Located in a recently constructed development project, the space comes with updated utilities and HVAC.
- Strong mix of local **residents, students, and professionals**. Over 70% of residents are college educated and above.

SITE PLAN

Atherton St - 27,000 CPD

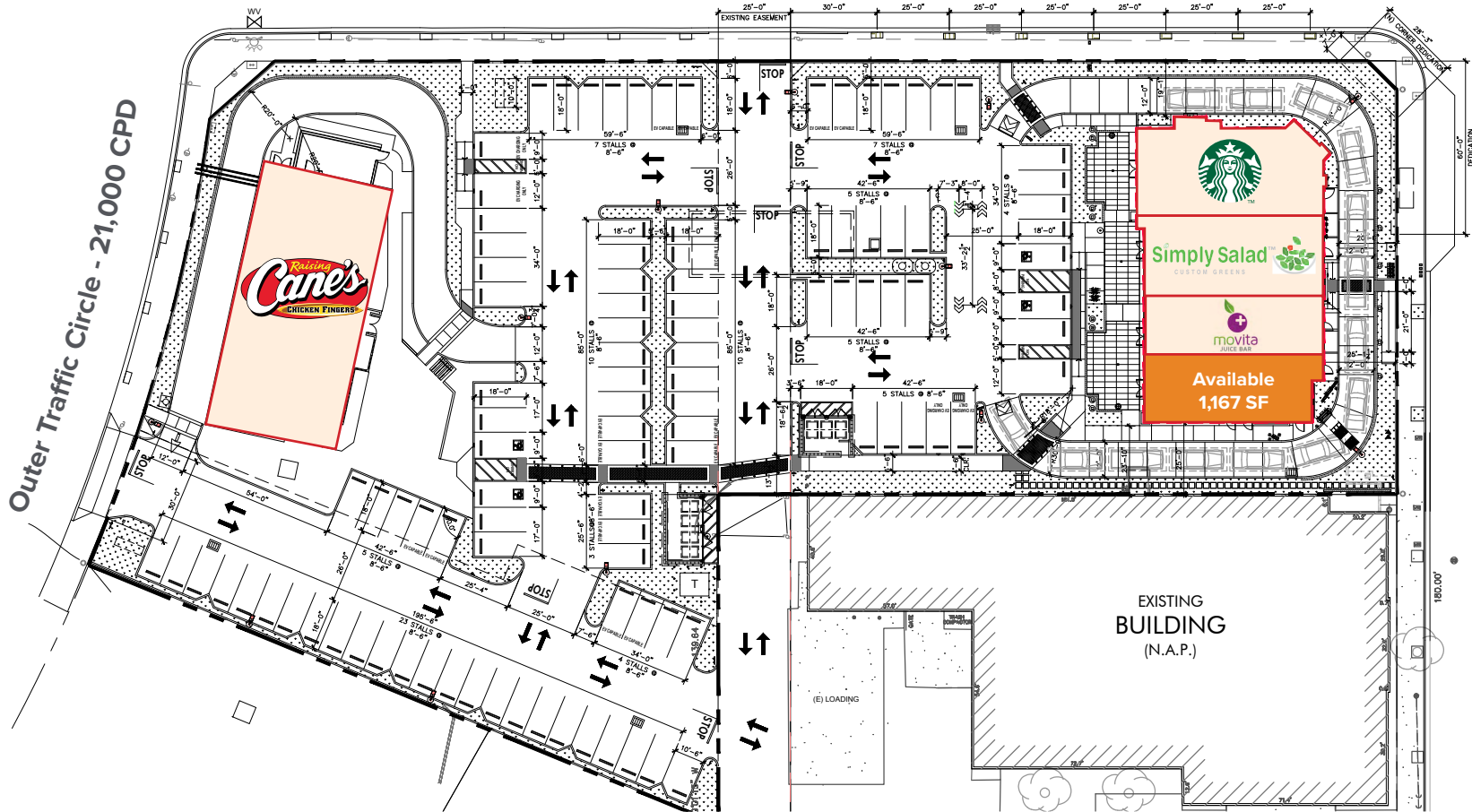

Outer Traffic Circle - 21,000 CPD

Ximeno Ave - 20,000 CPD

EXISTING BUILDING (N.A.P.)

- Raising Canes - Suite 4500 - 4,086
- Starbucks - 2,005 SF
- Simply Salad - 1,740 SF
- Movita Juice Bar - 1,250 SF

- Available - 1,167 SF

AREA LOCATION

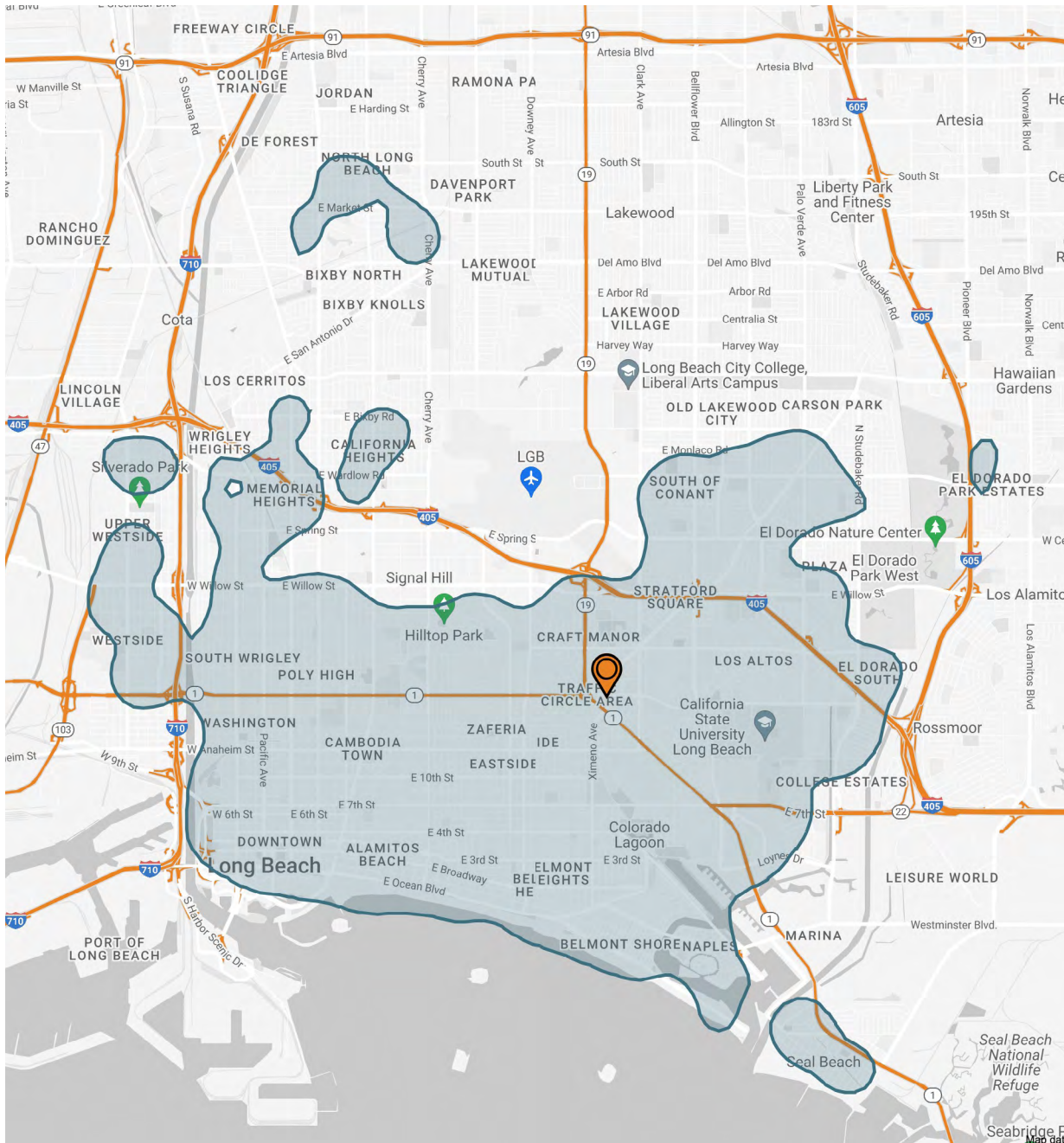

POPULATION

1 MILE	31,729
3 MILES	235,456
POLYGON	341,156



COLLEGE EDUCATED

1 MILE	70.8%
3 MILES	67.5%
POLYGON	64.8%



AVG. HOUSEHOLD INCOME

1 MILE	\$120,188
3 MILES	\$124,036
POLYGON	\$116,347



DAYTIME POPULATION

1 MILE	19,232
3 MILES	154,496
POLYGON	178,775

- The shading represents the customer trade area encompassing 70% of the traffic volume from Placer.ai over the last 12 months.
- High traffic center with 2.9 Visits Annually.

AREA RETAIL MAP

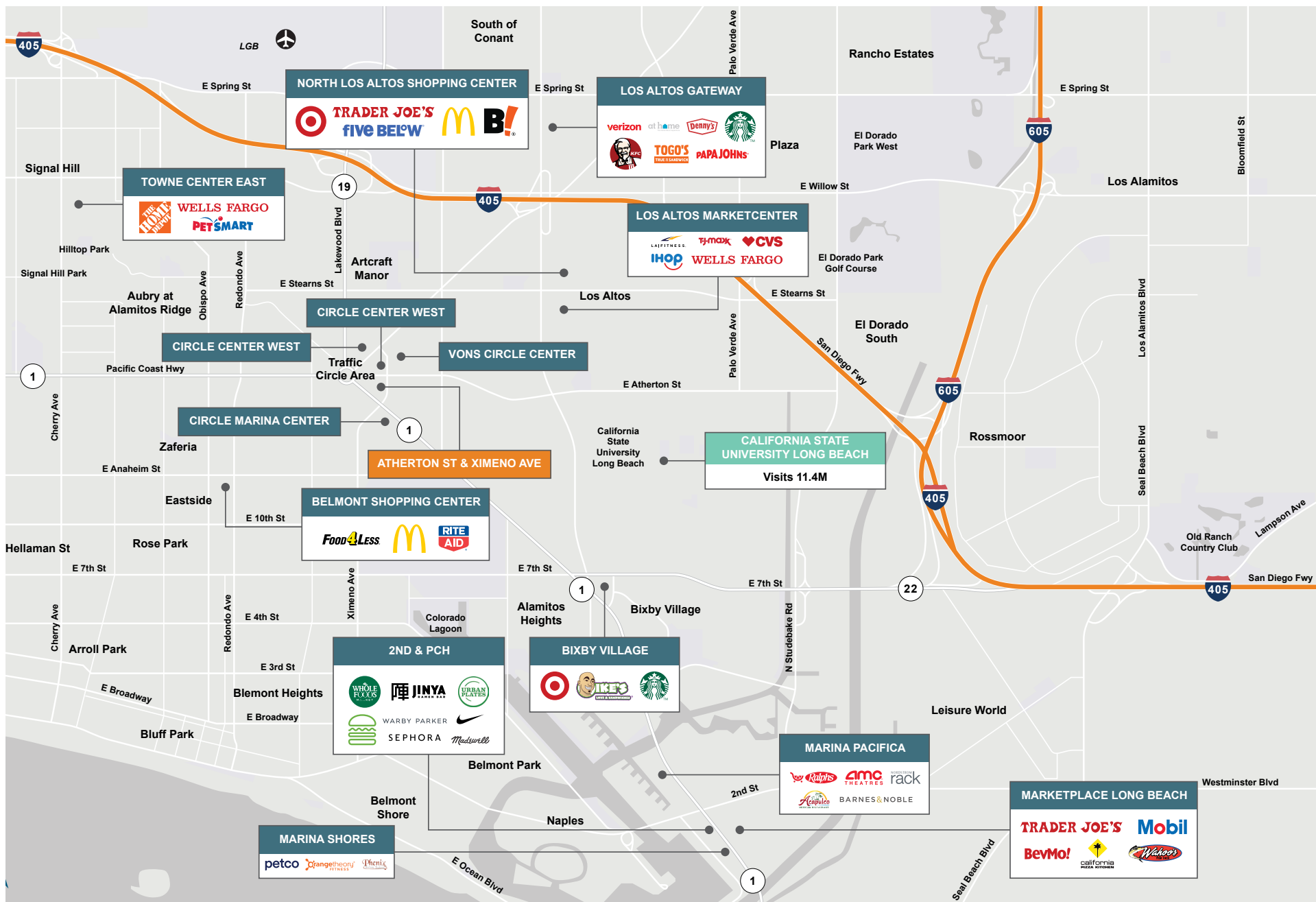

For leasing, please contact:

Mitchell Hernandez

Lic. 01875229

T +1 310 430 7790 x 102

mitchell.hernandez@betaagency.com

Richard Rizika

Lic. 01044064

T +1 310 430 7790 x 101

richard.rizika@betaagency.com



beta.

BetaAgency.com

137 Eucalyptus Dr

El Segundo, CA 90245

©2024 Beta. This information has been obtained from sources believed reliable however we cannot guarantee its accuracy. All marks, logos and photos displayed on this document are the property of their respective owners.