

FOR LEASE | ±2,348 SF AVAILABLE

# SECOND GENERATION RESTAURANT

NEC S Alvarado Street & W 3rd Street | Echo Park | Los Angeles, CA

beta.

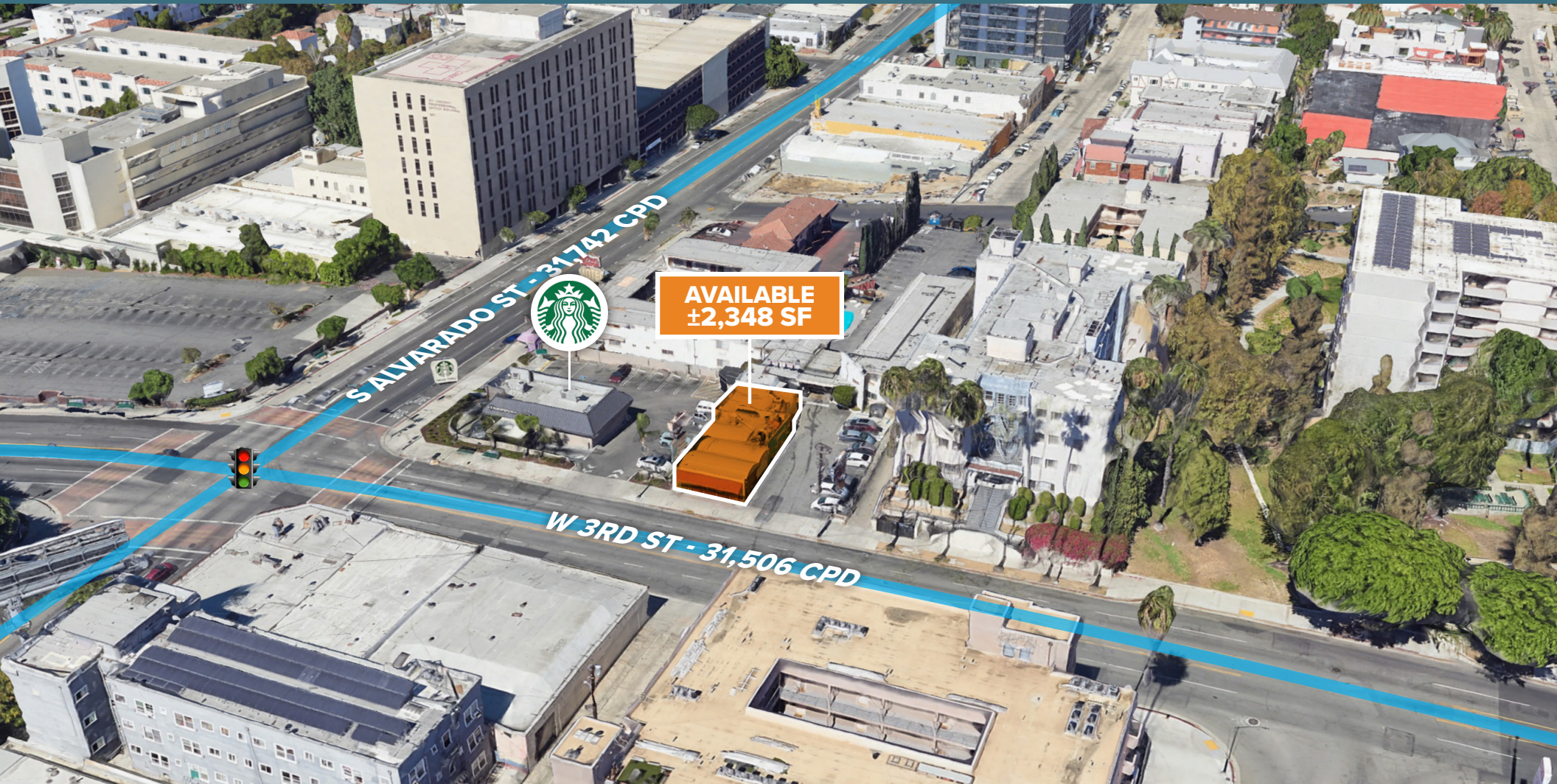

For leasing, please contact:

**MATT SAKER** | LIC. 02016706

T 424 282 5236 E [Matt.Saker@BetaAgency.com](mailto:Matt.Saker@BetaAgency.com)

[BetaAgency.com](https://betaagency.com)

137 Eucalyptus Blvd  
El Segundo, CA 90245

©2023 Beta Agency, Inc. The information contained in this document (or provided verbally) has been obtained from sources believed reliable. While Beta Agency, Inc. and Owner does not doubt its accuracy, Beta Agency, Inc. and Owner have not verified it and makes no guarantee warranty or representation about it. It is your responsibility to independently confirm its accuracy. Any projections, opinions, assumptions, approximations or estimates used are for example only and do not represent the current or future characteristics or performance of the property. The value of this transaction to you depends on tax and other factors which should be evaluated by your tax, financial and legal advisors. You and your advisors should conduct a careful, independent investigation of the property to determine to your satisfaction the suitability of the property meet your needs.



# PROJECT HIGHLIGHTS

- ±2,348 SF Fully equipped 2nd generation restaurant available in great Echo Park location
- Located at Signalized Intersection of Alvarado & 3rd St (Approx. 63,000 Cars Per Day)
- Proximity to 101 & 10 freeways
- Very dense population demographics (Approx. 126,000 residents in a 1-mile radius)
- Minutes from Silver Lake, DTLA, Hollywood & Silverlake

## DEMOGRAPHICS:

	1 Mile	3 Miles	5 Miles
Total Households	45,876	226,134	450,087
Total Population	126,202	590,649	1.23 M
Avg. Household Income	\$61,083	\$76,875	\$86,681

## SURROUNDING RETAILERS:



# FLOOR PLAN

W 3RD ST | 31,506 CPD

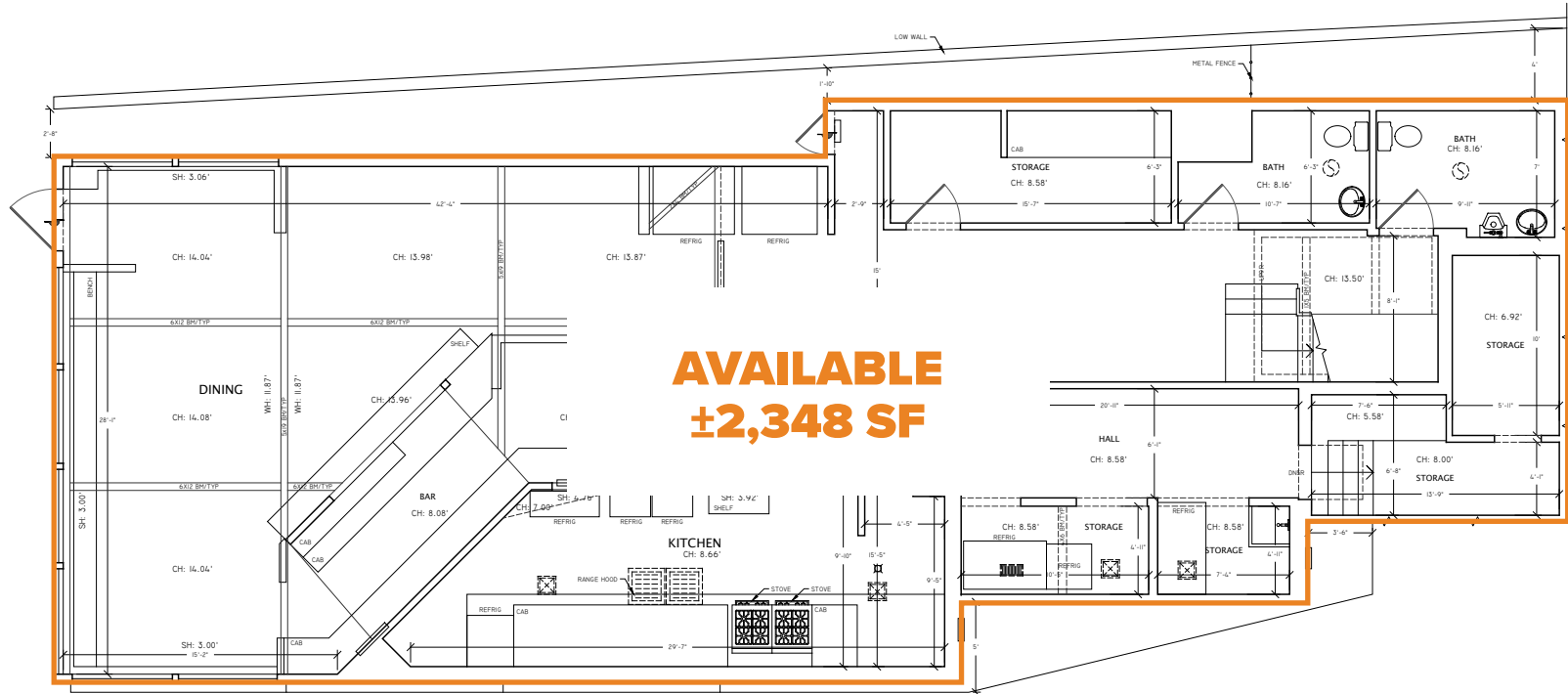



# AREA OVERVIEW



Image Landsat / Copernicus



# DEMOGRAPHIC REPORT

Population	1 Mile	3 Mile	5 Mile
Total population	126,202	590,649	1.23 M
Average age	33.8	35.4	35.1
Average age (Male)	33.2	34.8	34.5
Average age (Female)	34.8	36.3	35.9
Households & Income	1 Mile	3 Mile	5 Mile
Total households	45,876	226,134	450,087
# of persons per HH	2.7	2.4	2.6
Average HH income	\$61,083	\$76,875	\$86,681
Average house value	\$749,060	\$881,799	\$883,578
Race (%)	1 Mile	3 Mile	5 Mile
White	20.9%	25.2%	27.4%
Hispanic	60.0%	50.3%	53.7%
Black	6.8%	8.1%	9.9%
Asian	19.9%	22.5%	15.7%
Hawaiian	-	0.1%	0.1%
American Indian	3.5%	2.2%	2.1%
Other	27.5%	23.8%	23.6%

