

NEW CONSTRUCTION

# 10,000 - 40,000 SF AVAILABLE FOR LEASE

3017 - 3045 Crenshaw Blvd | Los Angeles, CA

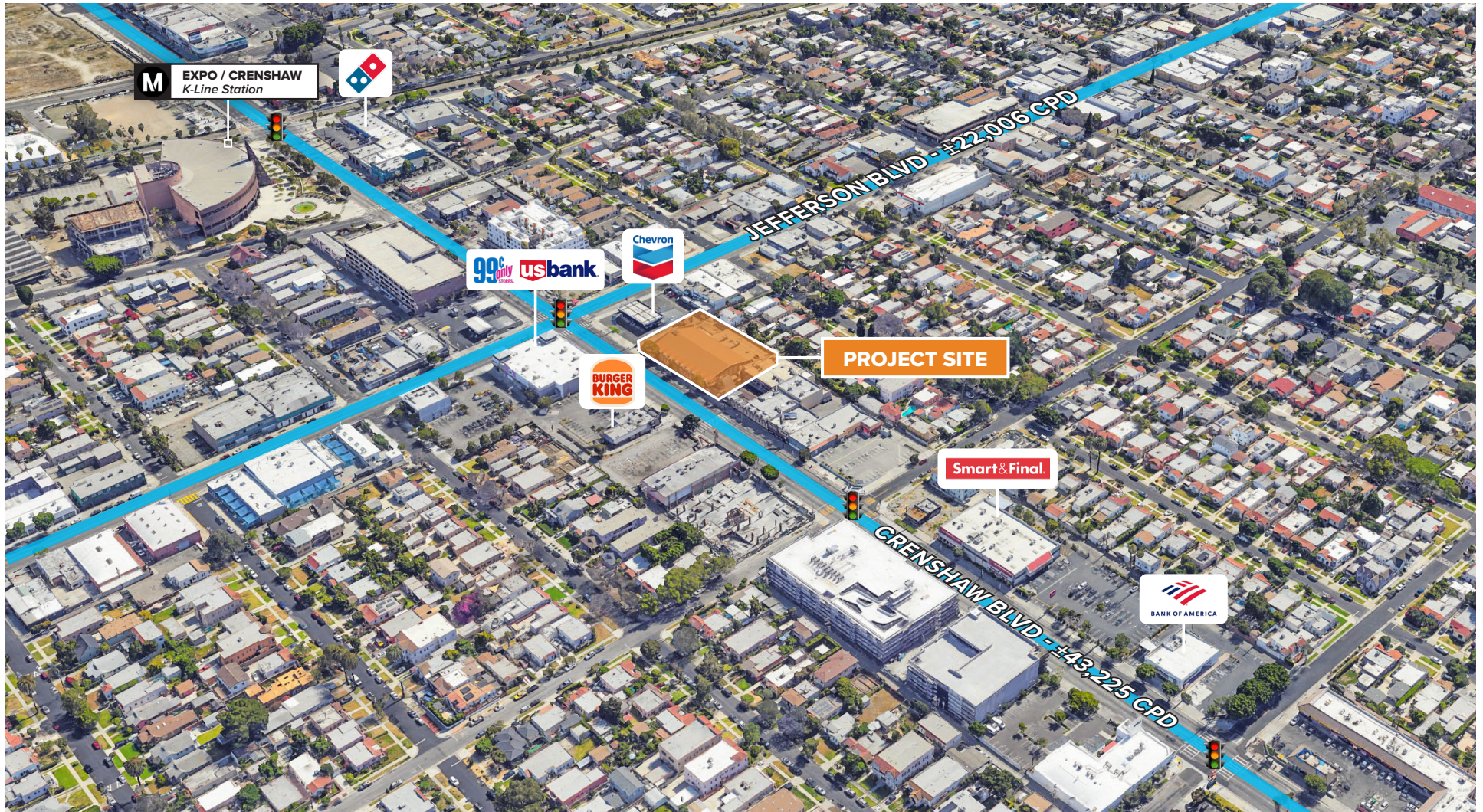

For leasing, please contact:

**VANESSA ZHANG** | LIC. 01921274

T 424 293 3696 E [Vanessa.Zhang@BetaAgency.com](mailto:Vanessa.Zhang@BetaAgency.com)

**XAN SAKS** | LIC. 01884636

T 310 529 4606 E [Xan.Saks@BetaAgency.com](mailto:Xan.Saks@BetaAgency.com)

**RICHARD RIZIKA** | LIC. 01044064

T 310 430 7790 x101 E [Richard.Rizika@BetaAgency.com](mailto:Richard.Rizika@BetaAgency.com)

**beta.**

# PROJECT HIGHLIGHTS

- First class mixed-use project featuring 168 residential units above ±40,000 SF ground floor retail
- Prominent street visibility and parking accessibility with 136 dedicated retail spaces
- Located near Crenshaw Blvd and Jefferson Blvd with over 65,000 CPD (Crenshaw Blvd: ±43,225, Jefferson Blvd: ±22,006)
- Positioned to serve the affluent and densely populated communities of Jefferson Park, West Adams and Leimert Park



# DEMOGRAPHIC SUMMARY



## RESIDENTIAL POPULATION

1 MILE  
**41,628**

2 Miles  
**185,195**

3 Miles  
**402,091**



## DAYTIME POPULATION

1 MILE  
**21,123**

2 Miles  
**91,766**

3 Miles  
**241,209**



## AVG. HOUSEHOLD INCOME

1 MILE  
**\$93,081**

2 Miles  
**\$94,850**

3 Miles  
**\$103,546**



# CONCEPTUAL SITE PLAN

## Ground Level Plan

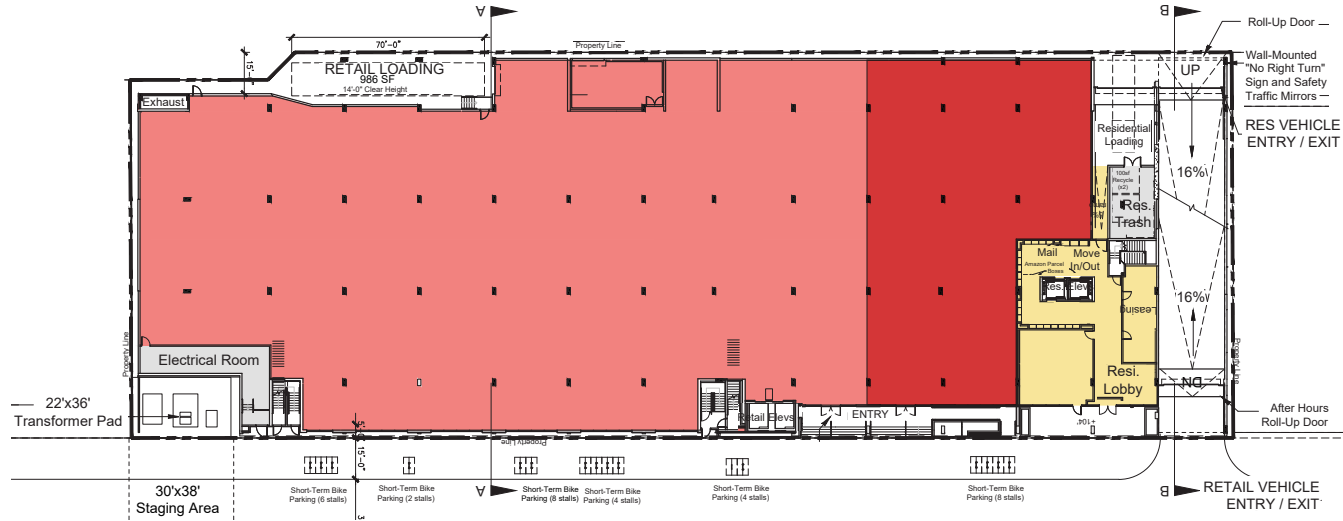

CRENSHAW BLVD | ±43,225 CPD

## Retail Parking Level

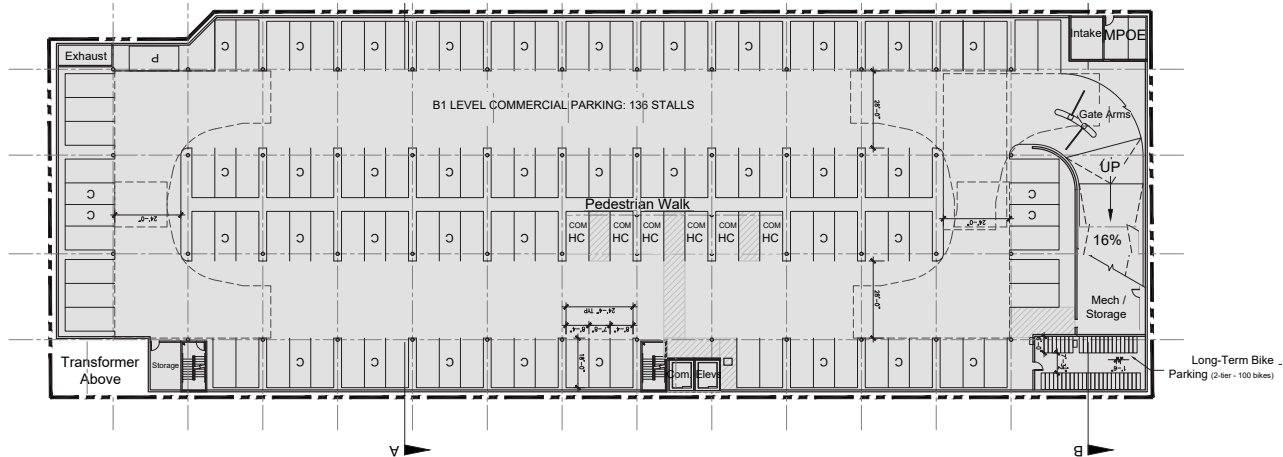

CRENSHAW BLVD | ±43,225 CPD

# AREA OVERVIEW

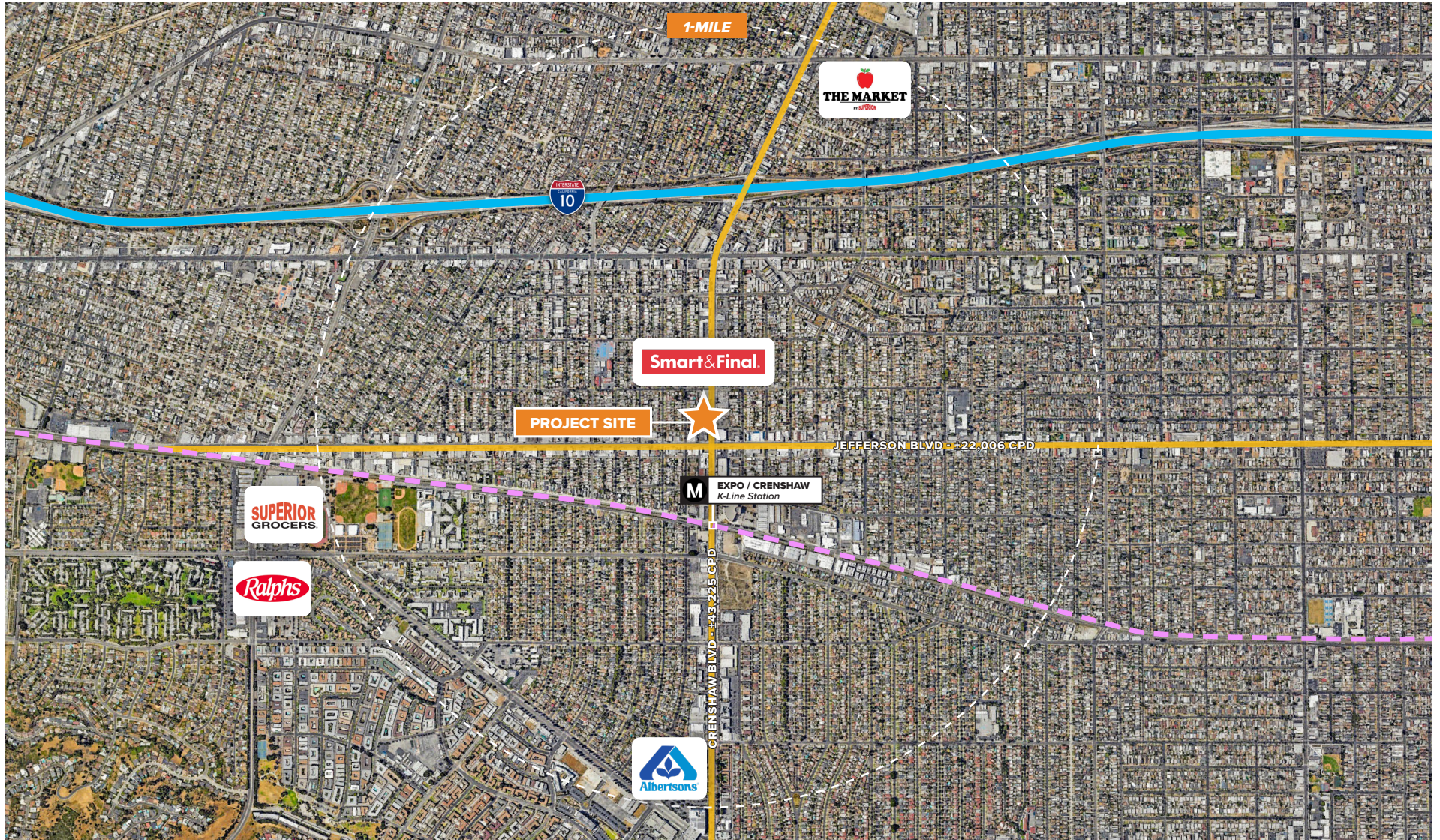

For leasing, please contact:

**VANESSA ZHANG** | LIC. 01921274

T 424 293 3696 E [Vanessa.Zhang@BetaAgency.com](mailto:Vanessa.Zhang@BetaAgency.com)

**XAN SAKS** | LIC. 01884636

T 310 529 4606 E [Xan.Saks@BetaAgency.com](mailto:Xan.Saks@BetaAgency.com)

**RICHARD RIZIKA** | LIC. 01044064

T 310 430 7790 x101 E [Richard.Rizika@BetaAgency.com](mailto:Richard.Rizika@BetaAgency.com)

[BetaAgency.com](http://BetaAgency.com)

137 Eucalyptus Blvd  
El Segundo, CA 90245