

JUNIOR ANCHOR OPPORTUNITY FOR LEASE | ±14,800 SF

NWC Hollywood Blvd & Western Ave | Hollywood, CA

HARBOR FREIGHT
QUALITY TOOLS | LOWEST PRICES

AVAILABLE
±14,800 SF

LAZY ACRES
natural market

Orangetheory
FITNESS | EVERY TABLE

FarmerBoys
BREAKFAST BURGERS & MORE

Marshalls

CHASE

jamba

DAISO
JAPAN

NORMS
RESTAURANTS

Jersey Mike's
SUBS

ROSS
DRESS FOR LESS

Ralphs

The UPS Store 

WESTERN AVE | ±34,235 CPD



HOLLYWOOD BLVD | ±33,949 CPD

For leasing, please contact:

Randi Cohen

Lic. 02135211

T 310 430 7790

Randi.Cohen@BetaAgency.com

Richard Rizika

Lic. 01044064

Richard.Rizika@BetaAgency.com

beta.

BetaAgency.com

137 Eucalyptus Dr, El Segundo, CA 90245

©2024 Beta Agency, Inc. The information contained in this document (or provided verbally) has been obtained from sources believed reliable. While Beta Agency Inc. does not doubt its accuracy, Beta Agency Inc. has not verified it and makes no guarantee warranty or representation about it. It is your responsibility to independently confirm its accuracy. Any projections, opinions, assumptions or estimates used are for example only and do not represent the current or future performance of the property. The value of this transaction to you depends on tax and other factors which hold be evaluated by your tax, financial and legal advisors. You and your advisors should conduct a careful, independent investigation of the property to determine to your satisfaction the suitability of the property meet your needs.



PROJECT HIGHLIGHTS

- **FOR LEASE | ±14,800 SF**
- Densely populated trade area
- Daytime population exceeds 127,000 within 2 miles
- Traffic count exceeds 69,000 CPD
- 0.4 miles from the 101 Freeway
- Close proximity to Los Angeles City College (population of ±14,000)

DEMOGRAPHICS

	1 Mile	2 Miles	3 Miles
 Population	63,138	182,721	362,426
 Daytime Population	37,472	127,081	252,617
 Avg. Household Income	\$97,712	\$112,382	\$122,946



© 2024 Beta Agency, Inc. The information contained in this document (or provided verbally) has been obtained from sources believed reliable. While Beta Agency Inc. does not doubt its accuracy, Beta Agency Inc. has not verified it and makes no guarantee, warranty or representation about it. It is your responsibility to independently confirm its accuracy. Any projections, opinions, assumptions or estimates used are for example only, and do not represent the current or future performance of the property. The value of this transaction to you depends on tax and other factors which hold be evaluated by your tax, financial and legal advisors. You and your advisors should conduct a careful, independent investigation of the property to determine to your satisfaction the suitability of the property meet your needs.

SITE PLAN

HOLLYWOOD
& WESTERN

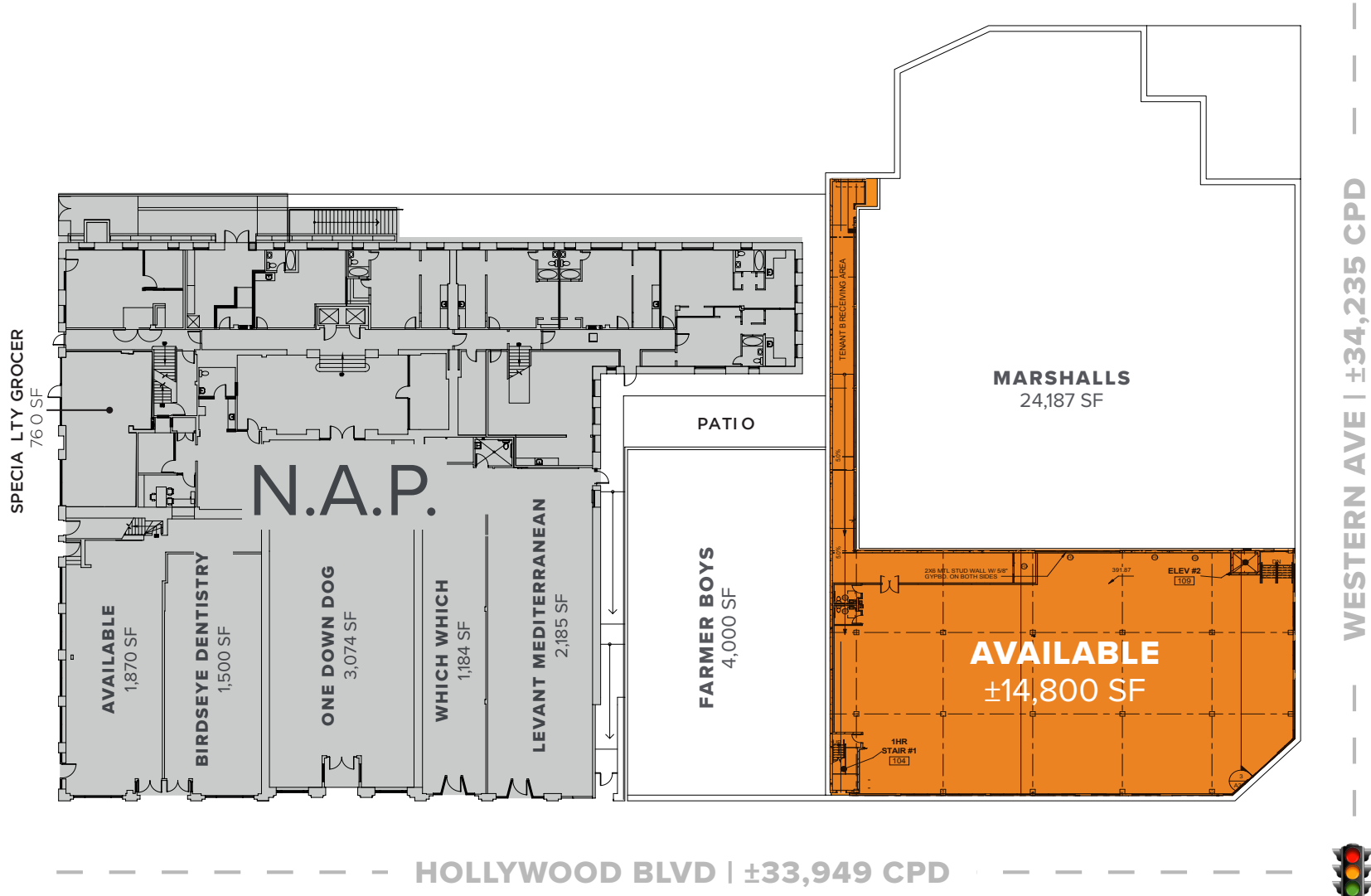

FLOOR PLAN

HOLLYWOOD
& WESTERN

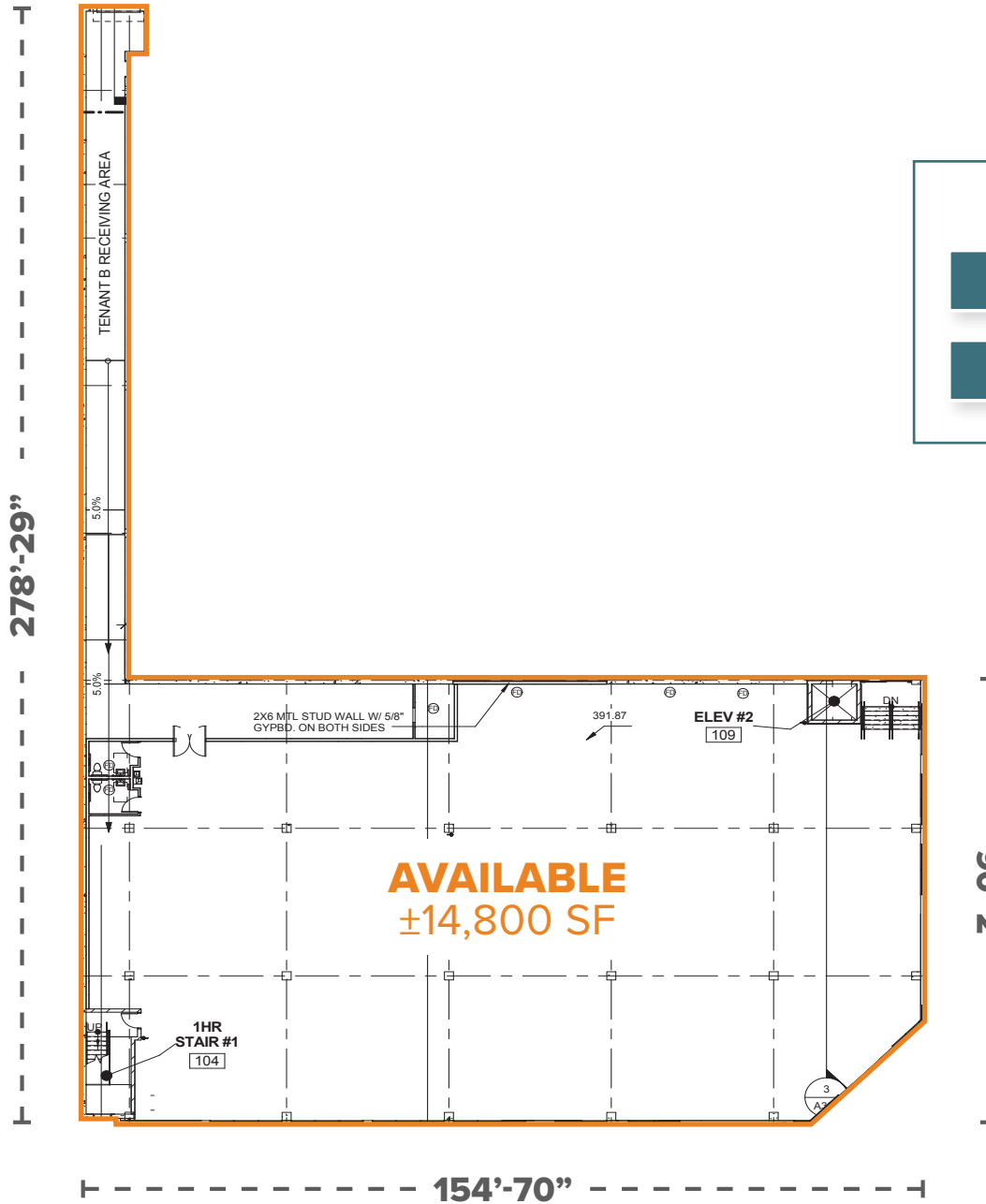

CLICK FOR:

EXTERIOR PHOTOS

INTERIOR PHOTOS

AVAILABLE
±14,800 SF

JUNIOR ANCHOR OPPORTUNITY

FOR LEASE | ±14,800 SF

NWC Hollywood Blvd & Western Ave | Hollywood, CA

HOLLYWOOD & WESTERN



For leasing, please contact:

Randi Cohen

Lic. 02135211

T 310 430 7790

Randi.Cohen@BetaAgency.com

Richard Rizika

Lic. 01044064

Richard.Rizika@BetaAgency.com

©2024 Beta Agency, Inc. The information contained in this document (or provided verbally) has been obtained from sources believed reliable. While Beta Agency Inc. does not doubt its accuracy, Beta Agency Inc. has not verified it and makes no guarantee warranty or representation about it. It is your responsibility to independently confirm its accuracy. Any projections, opinions, assumptions or estimates used are for example only and do not represent the current or future performance of the property. The value of this transaction to you depends on tax and other factors which hold to be evaluated by your tax, financial and legal advisors. You and your advisors should conduct a careful, independent investigation of the property to determine to your satisfaction the suitability of the property meet your needs.

beta.

BetaAgency.com

137 Eucalyptus Dr, El Segundo, CA 90245