

RETAIL SPACE AVAILABLE | ±6,960-9,941 SF

PRIME SHOP SPACE IN LAKEWOOD

NEC Lakewood Blvd & South St | Lakewood, CA



For leasing, please contact:

MATT SAKER | LIC. 02016706
T 424 282 5236 E Matt.Saker@BetaAgency.com

MITCHELL HERNANDEZ
LIC. 02016706

BetaAgency.com
137 Eucalyptus Dr, El Segundo, CA 90245

©2024 Beta Agency, Inc. The information contained in this document (or provided verbally) has been obtained from sources believed reliable. While Beta Agency Inc. does not doubt its accuracy, Beta Agency Inc. has not verified it and makes no guarantee warranty or representation about it. It is your responsibility to independently confirm its accuracy. Any projections, opinions, assumptions or estimates used are for example only and do not represent the current or future performance of the property. The value of this transaction to you depends on tax and other factors which hold to be evaluated by your tax, financial and legal advisors. You and your advisors should conduct a careful, independent investigation of the property to determine to your satisfaction the suitability of the property meet your needs.

PROPERTY HIGHLIGHTS

- **±6,960 – 9,941 SF** of Retail Shop Space located on prime Lakewood Blvd and South St, a high-traffic commercial corridor which see’s an upwards of **60,000 CPD**.
- Convenient access to major freeways, including I-605 and I-91.
- On Site Parking with **39 parking spaces**
- High visibility with prominent Pylon signage.
- **Versatile Layout** adaptable to various retail or showroom configurations.
- Close Proximity to Lakewood Center, home to Macy’s, Target, Costco, H&M, Burlington, Foot Locker, and Hollister, California Pizza Kitchen, Buffalo Wild Wings, Raising Canes, and More



POPULATION

| 1 mile | 2 mile | 3 mile |
|---------------|----------------|----------------|
| 28,267 | 122,456 | 252,017 |



AVG. HOUSEHOLD INCOME

| 1 mile | 2 mile | 3 mile |
|------------------|------------------|------------------|
| \$133,316 | \$121,262 | \$117,383 |



DAYTIME POPULATION

| 1 mile | 2 mile | 3 mile |
|---------------|---------------|----------------|
| 20,926 | 69,357 | 154,528 |



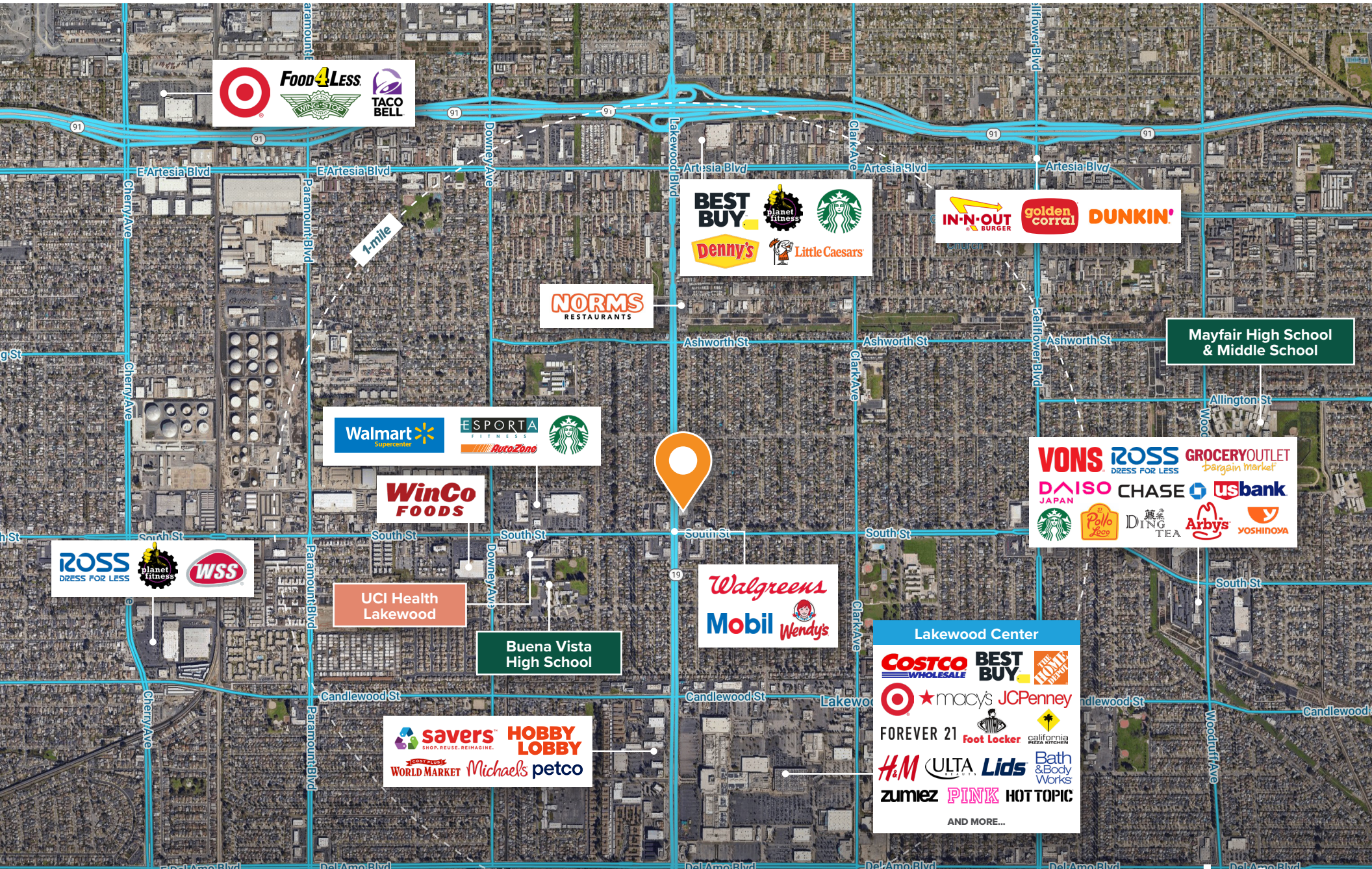

©2024 Beta Agency, Inc. The information contained in this document (or provided orally) has been obtained from sources believed reliable. While Beta Agency Inc. does not doubt its accuracy, Beta Agency Inc. has not verified it and makes no guarantee, warranty or representation about it. It is your responsibility to independently confirm its accuracy. Any projections, opinions, assumptions or estimates used are, for example only, and do not represent the current or future performance of the property. The value of this transaction to you depends on tax and other factors which hold to be evaluated by your tax, financial and legal advisors. You and your advisors should conduct a careful, independent investigation of the property to determine to your satisfaction the suitability of the property for your needs.

DETAILS

- **Zoning:** C3
- **Loading Area:** Equipped with 10 X 16 rolling door in the rear of premises for convenient loading/unloading
- **Ceiling heights:** 16 FT
- **Condition:** Well-maintained exterior and interior, and soon to be newly paved parking lot, ready for immediate occupancy
- 600 Amp, 240 volt, 3phase, 4 wire electrical service

LAKWOOD BLVD

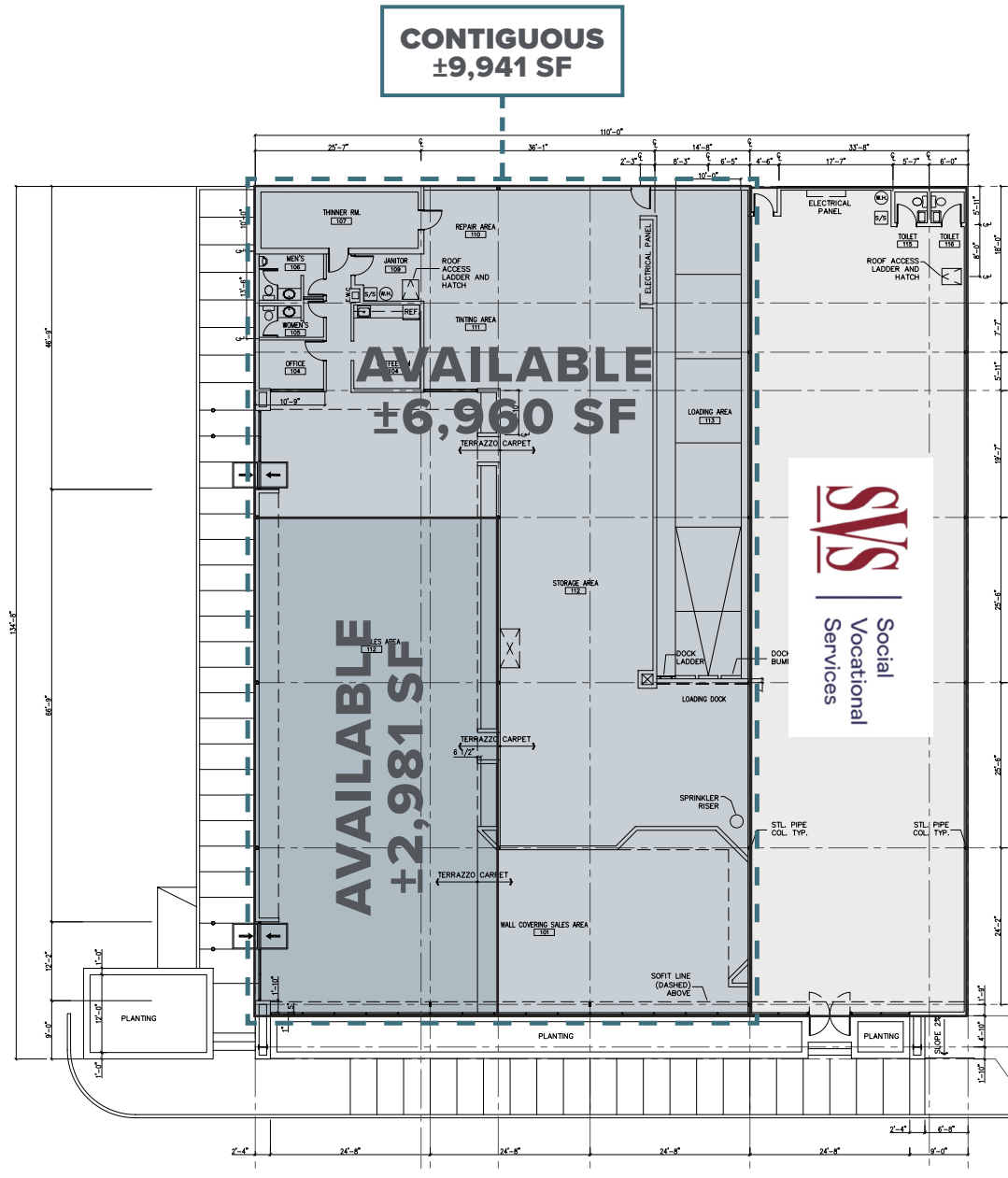

Demographics

| Population | 1 Mile | 2 Mile | 3 Mile |
|----------------------|--------|---------|---------|
| Total population | 28,267 | 122,456 | 252,017 |
| Average age | 37.6 | 37.2 | 36.9 |
| Average age (Male) | 36.6 | 36.2 | 35.9 |
| Average age (Female) | 38.6 | 38.2 | 37.9 |

| Households & Income | 1 Mile | 2 Mile | 3 Mile |
|---------------------|-----------|-----------|-----------|
| Total households | 9,194 | 40,408 | 82,066 |
| # of persons per HH | 3.0 | 3.0 | 3.0 |
| Average HH income | \$133,316 | \$121,262 | \$117,383 |
| Average house value | \$709,117 | \$715,972 | \$712,413 |

| Race (%) | 1 Mile | 2 Mile | 3 Mile |
|-----------------|--------|--------|--------|
| White | 29.9% | 28.8% | 28.0% |
| Hispanic | 41.5% | 45.6% | 48.7% |
| Black | 15.1% | 14.6% | 13.8% |
| American Indian | 1.1% | 1.2% | 1.4% |
| Asian | 17.8% | 15.8% | 15.0% |
| Hawaiian | 1.1% | 1.1% | 0.9% |
| Other | 20.3% | 23.5% | 25.6% |

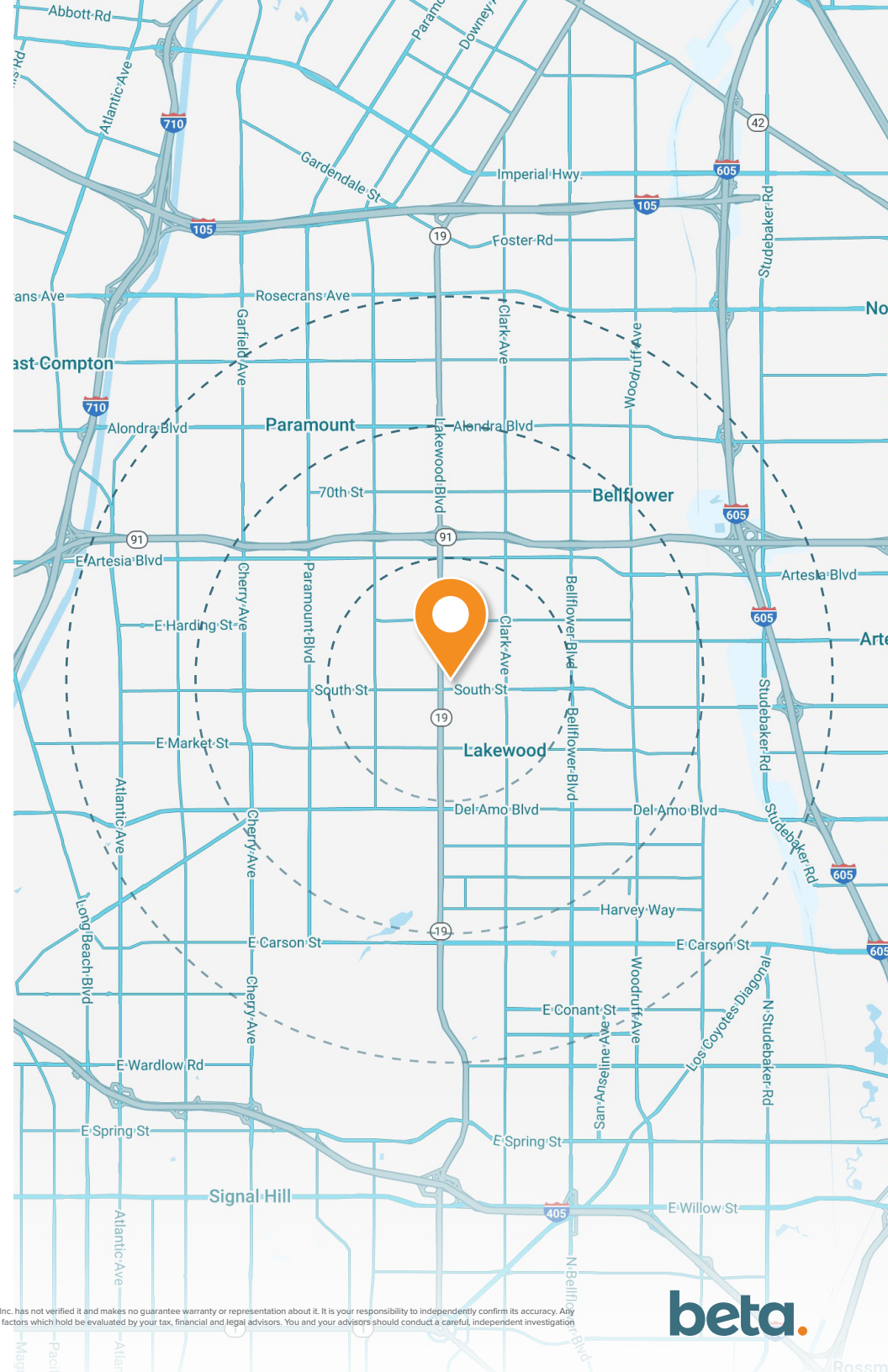

©2024 Beta Agency, Inc. The information contained in this document (or provided verbally) has been obtained from sources believed reliable. While Beta Agency Inc. does not doubt its accuracy, Beta Agency Inc. has not verified it and makes no guarantee warranty or representation about it. It is your responsibility to independently confirm its accuracy. Any projections, opinions, assumptions or estimates used are for example only and do not represent the current or future performance of the property. The value of this transaction to you depends on tax and other factors which hold be evaluated by your tax, financial and legal advisors. You and your advisors should conduct a careful, independent investigation of the property to determine to your satisfaction the suitability of the property meet your needs.



PRIME RETAIL SPACE IN LAKEWOOD

NEC Lakewood Blvd & South St | Lakewood, CA

SHOP SPACE
AVAILABLE

±6,960-9,941 SF

For leasing, please contact:

MATT SAKER | LIC. 02016706
T 424 282 5236 E Matt.Saker@BetaAgency.com

MITCHELL HERNANDEZ
LIC. 02016706

beta.

©2024 Beta Agency, Inc. The information contained in this document (or provided verbally) has been obtained from sources believed reliable. While Beta Agency, Inc. does not doubt its accuracy, Beta Agency, Inc. has not verified it and makes no guarantee warranty or representation about it. It is your responsibility to independently confirm its accuracy. Any projections, opinions, assumptions or estimates used are for example only and do not represent the current or future performance of the property. The value of this transaction to you depends on tax and other factors which hold be evaluated by your tax, financial and legal advisors. You and your advisors should conduct a careful, independent investigation of the property to determine to your satisfaction the suitability of the property meet your needs.

BetaAgency.com
137 Eucalyptus Dr, El Segundo, CA 90245